

PastPorts

NEWS AND TIPS FROM THE ST. LOUIS COUNTY LIBRARY SPECIAL COLLECTIONS DEPARTMENT

VOL. 6, NO. 2—FEBRUARY 2013

FOR THE RECORDS

Gatewood Gardens Cemetery

Gatewood Gardens Cemetery (GG), as it is currently known, is an important one in the history of the St. Louis German-American community and one that researchers often encounter. It is also one that causes much confusion. The Special Collections Department has recently acquired GG records on 29 rolls of microfilm covering 1877 to 2001. The following information offers a brief clarification of the cemetery's history and an explanation of records available on microfilm.

History*

GG's story actually begins with an older, unrelated cemetery. When Holy Ghost German Evangelical Church, under the leadership of the Rev. Friedrich Picker, established Holy Ghost Cemetery in 1846 (see Figure 1, Property A and maps on page 2). This cemetery was located four miles northeast of the GG on Gravois Road on land now occupied by Roosevelt High School. Burials were performed as late as 1903, but community pressure caused the city to condemn it, and the property was sold for redevelopment in 1917.

In 1856, Picker and a group of members left Holy Ghost Church and established Independent German Evangelical Protestant Congregation (now Christ the King United Church of Christ in Florissant). That same year, the congregation established Independent German Evangelical Protestant Cemetery on 12-1/2 acres of land on the south side of Gravois Road near the River Des Peres (Property B). The

* For more about GG's history, see Mike McDermott's "Pastor Frederick Picker: Pastor Frederick Picker's St. Louis Churches and Cemeteries" in *St. Louis Genealogical Society Quarterly*, Vol. 36: 2 (Summer 2003), R 977.865 S145

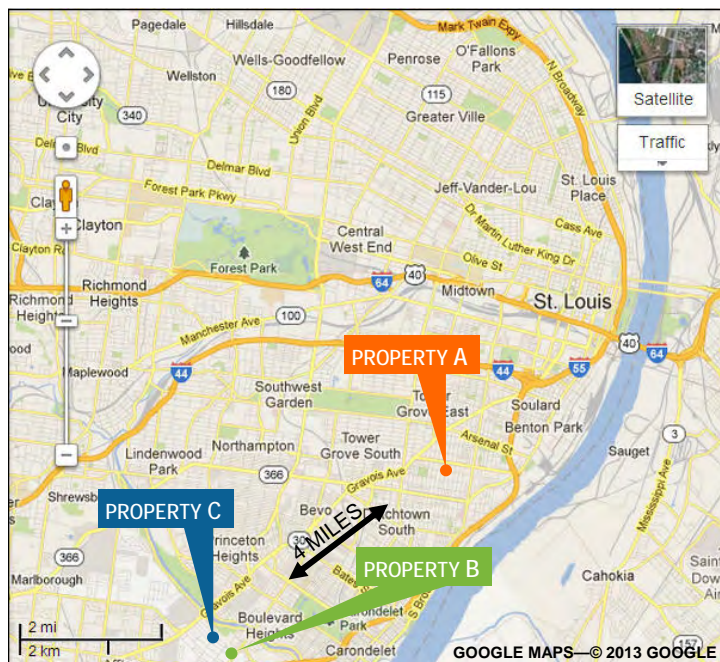

Figure 1 | Overview map showing relative locations of cemetery properties in the city of St. Louis

cemetery was expanded in 1881, when 28 acres were added on the north side of Gravois and expanded again in 1901 with 28 adjoining acres (both additions are represented as a unit by Property C). When Holy Ghost Cemetery closed in 1917, many graves were moved to GG.

Independent Evangelical Protestant Congregation sold the cemetery (Properties B and C) in 1978, and the new owners changed the name to St. Louis Memorial Gardens. The property declined as it went through a further change of ownership until the City of St. Louis seized it for back taxes in 1996. Since then, it has been

CONTINUED ON PAGE 3



St. Louis County Library

A tale of three cemetery properties

The “Picker” cemetery properties in brief

PROPERTY A

Initial Name: Holy Ghost Cemetery

Later Names or nicknames: Picker's, Old Picker's, Picot's, Picotte's

Location: Near Gravois and Compton on Susquehanna St., now Arsenal St.

Founded by: German Evangelical Protestant Church of the Holy Ghost, the Rev. Fr. Picker, pastor

Purchased / opened: Nov. 2, 1846

Additional land purchased: April 25, 1853

Last burial: May 13, 1903

Closed: 1917, by city order

Current property use: location of Roosevelt High School

Graves moved after closure: to St. Marcus, Zion Evangelical, Bellefontaine, St. Peter's, and Independent Evangelical Protestant Cemetery (a.k.a. New Picker's) cemeteries

SLCL Films: EVUC 18–20 and SLCEM-67



PROPERTY B

Initial name: Independent Evangelical Protestant Cemetery

Later names or nicknames: New Picker's, Old Picker's, St. Louis Memorial Gardens, Gatewood Gardens

Location: Gravois Rd. at Hampton (south side of Gravois)

Founded by: Independent German Evangelical Protestant Church, the Rev. Fr. Picker, pastor

Purchased / opened: Opened 1856; in 1996, the cemetery, then named Gatewood Gardens, was seized by City of St. Louis for back taxes

Current status: Gatewood Gardens Cemetery (old side)

SLCL films: SLCEM 96–124

PROPERTY C

Initial name: New Pickers (name at time of addition is uncertain)

Later names or nicknames: St. Louis Memorial Gardens, Gatewood Gardens

Location: Gravois Rd. at Hampton (north side of Gravois)

Founded by: Independent Evangelical Protestant Church

Purchased: Added as additions to the Independent Evangelical Protestant Cemetery in 1881 and 1921

Closed: In 1996, the cemetery, then named Gatewood Gardens, was seized by City of St. Louis for back taxes

Current status: Gatewood Gardens Cemetery (new side)

SLCL Films: SLCEM 96–124

managed by the St. Louis Land Redevelopment Corporation, under the name Gatewood Gardens.

As this history illustrates, confusion occurs, because:

1. Frederick Picker was the pastor of the two congregations that founded Holy Ghost Cemetery (Property A) and GG (Property B and Property C).
2. As a result, the name “Picker” has been connected to all three properties either formally or informally.
3. When Holy Ghost was closed, GG was one of five cemeteries to receive bodies for reburial.

Overview of the records

The records acquired by St. Louis County Library pertain specifically to the cemetery now known as Gatewood Gardens (Property B and Property C on the diagram). Records are included on 29 rolls of film (SLCEM 97 – SLCEM-124 in drawer 53). Records created before 1877 are not known to exist and are not included in the filming. The rolls

PastPorts is published monthly by the St. Louis County Library Special Collections Department, located on Tier 5 of the Headquarters location.

Current and past issues can be downloaded from the web at <http://www.slcl.org/pastports>.

Contact the Special Collections Department
 Special Collections Department
 St. Louis County Library
 1640 S. Lindbergh Blvd
 St. Louis, MO 63131

Phone: 314-994-3300, ext. 2070
 Email: scollections@slcl.org
 Website: <http://www.slcl.org>

Tours

Tours of the Special Collections Department are conducted on the first Wednesday and third Saturday of the month at 10:30 a.m. No registration is required. Group tours are gladly arranged with advance notice by calling the Special Collections Department at 314-994-3300, ext. 2070.

include a table of contents and title target sheets that help orient the user to the material.

Background

The illustration on page 2, showing three pieces of cemetery property designated as Properties A, B, and C, will help to explain the background of this cemetery and its multiple names. The following chart shows phrases used to designate the two parts of GG:

Property shown on diagram	Sometimes referred to as	Areas within property defined by
B	Old side South of Gravois	Blocks (Roman Numerals I–VI)
C	New Side North of Gravois	Sections (Letters A–Q)

Searching the records

To find a burial, begin by searching online at the [Gatewood Gardens Cemetery website](http://tinyurl.com/azaxnlp) <<http://tinyurl.com/azaxnlp>>.

Researchers can search by name of the lot card holder, name of the buried person, comment, or burial year range. After selecting the type of search and entering the search term, it is important to click the search button beneath that particular dialog box to receive the correct search results (Figure 2, page 4). A successful search should return the date of burial, section, and lot number.

The search results screen will display up to four listings (Figure 3, page 4). If more matching records are found, a “View all records” hyperlink will appear next to the results. Click on the link to see the rest of the records, which may exceed 100 entries. A name with a hyperlink will offer additional information, such as others buried in the same lot. As an example of how “Search by comment” works, enter the term “pauper” and review the 194 results.

When the Land Reutilization Authority (LRA) acquired Gatewood Gardens Cemetery through tax foreclosure sale, it received incomplete records. According to the GG website, LRA estimates that the database represents 90% of the records and notes that the missing 10% are from Blocks II and IV in the old side of the cemetery (Property B). A note on the microfilm states that no records prior to 1877 were found for this cemetery.

Gatewood Gardens Cemetery Search Form

Select Language

On this page: Gatewood Gardens Cemetery Search Form. List names of all individuals buried in the cemetery.

Search Cemetery Database By

Name Of Lot Card Holder

[Search By Lot Card Holder](#)

Name of Buried Person

[Search by Buried Person](#)

Comment

[Search By Comment](#)

Burial Date
 From (yyyy)

 To (yyyy)

[Search by Burial Date](#)

Helpful Links
[Cemetery History](#)
[Interments](#)
[Cemetery Contact](#)

Figure 2 | The Gatewood Garden burial database can be searched multiple ways. Be sure to click on the “search” button below the field on which you want to search.

Other sources for finding GG burials are “St. Louis Burials,” Vol. 4 CD-ROM index (available on Special Collections Department public computers), “Old Cemeteries, St. Louis County, Missouri” (six print volumes, R 977.865 O44), family information, an obituary, the St. Louis Death Register, a death certificate, or probate records. While these sources do not provide the cemetery section/block and lot number, the date of death and/or cemetery of burial are good clues when searching for a common name.

The records in detail

The microfilm set includes seven types of records that, when used collectively, provide researchers with different perspectives.

Cemetery Information and History (appears near the beginning of each roll) | A one-page history provides a brief overview of the cemetery, although it does not completely agree with what others have written. It discusses Holy Ghost Cemetery, New Picker’s Cemetery, Memorial Gardens, and Gatewood Gardens through the transition when GG was seized by the City of St. Louis for more than \$200,000 in back taxes.

Lot Cards (rolls SLCEM-97 – SLCEM-118) | This series comprises more than half of the 29 rolls and includes lot owner cards. Each card lists the name and residence of the lot owner, a numbered list of the individuals buried in that lot with each person’s name, age, and date of death, and a lot diagram showing the location and approximate size of each casket (figure 4, page 5).

The cards are first divided into Sections A-Q (new side, north of Gravois or Property C) and Blocks I-VI (old side, south of Gravois or Property B) and then arranged in alphabetical order by lot owners’ names. Consult the chart (figure 6, page 6) to determine which film roll(s) to consider. Film box labels provide more detailed information to help pinpoint a specific roll.

Log Books (SLCEM-119 – SLCEM-122) | Six volumes list burials in chronological order for Aug. 11, 1877 through 2001. The information includes burial date, deceased person’s name, age, place of birth, place and cause of death, and the name and address of the attending physician. Records from the early years are faint and best viewed on the Special Collections Department’s new ViewScan microfilm readers (researchers should consult a staff member before using this equipment).

Lot map books (SLCEM-122 – SLCEM-123) | Discovering who occupies a burial lot is a way of connecting individuals to each other. Knowing who occupied neighboring lots is also important. Beside the list of lot burials appears a

THE CITY OF ST. LOUIS MISSOURI

Search the Site

Home » Government » Departments and Agencies » St. Louis Development Corporation » Real Estate » Gatewood Gardens Cemetery Search Form

Gatewood Gardens Cemetery Search Form

Select Language

On this page: Gatewood Gardens Cemetery Search Form. List names of all individuals buried in the cemetery.

Section: A Lot: 72 Lot Card Of Holder's Name : A, G.

4 of 14 records [View all records](#)

Grave #	Person	Burial Date	Comment
1	Rosie Sullivan (Hirshausen)	06/04/1902	Hirshausen
2	Charles Hirshausen	5/15/1951	
3	Anna Hirshausen	10/7/1957	
4	William Hirshausen	11/4/1918	

Helpful Links
[Cemetery History](#)
[Interments](#)
[Cemetery Contact](#)

Figure 3 | Searching will return abbreviated results. Click “View all records” to view the full list.

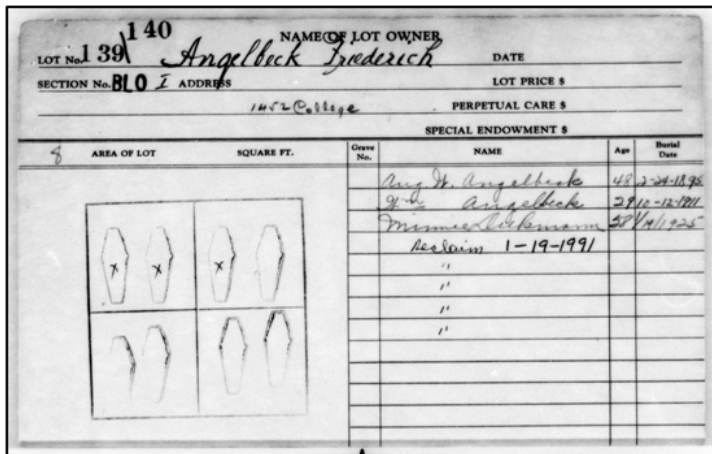

Figure 4 | A typical Gatewood Gardens Cemetery lot card

diagram showing the location of each person’s casket within the lot. Lot maps are organized by section, and then by lot number (Figure 5). Sometimes, a section listing begins with a diagram of the entire section showing the number and shows the location of each lot within the overall section. Such diagrams exist for sections A, B, C, G, H, and I (not to be confused with the Roman numeral). A map of GG is also located in the “Cemetery Maps” binder on the finding aids table in the Special Collections Department.

Lot Owner Books (SLCEM-123 – SLCEM-124) | The six books in this set provide an alphabetical index of lot owners for the “New Side of Gatewood Gardens Cemetery” (Property C) and includes (according to film notes at the beginning of each book) occasional information for the “Old Side of the Cemetery” (Property B). Although these pre-printed ledgers have two columns meant only for brief entries, the record keeper wrote the lot owner’s information across both columns and added extra information. The result shows each lot owner’s last name, first name, lot number, section, and address.

Lot owners for single graves appear in grid showing the layout of the graves. Each grid, one page in size, shows the graves by rows with each row subdivided into individual graves. Each rectangle representing a grave shows the grave number, name, and date.

Burial Listing Books (SLCEM-124) | Includes burial list-

ings of single graves for the “New Side of Gatewood Gardens” (Property C), 1916–1985, arranged in numerical order by grave number. Entries list the grave number, name of deceased, age, and burial date. Film notes at the beginning of these books state that grave numbers 1–487, 489, 1324–2000, and 2013–2048 are missing, as well as the “Personal Graves New Side Baby Row.”

Cemetery Deed Book (SLCEM-124) | The cemetery deed book applies only to the “New Side of Gatewood Gardens” (Property C). Records are arranged by section (A, B, C, etc.) and then numerically by lot number. Entries record the size of lot, lot purchaser, deed number, and if it was transferred.

Case study using GG records

Frank Volek died Sept. 10, 1933 and was buried on Sept. 12 in New Pickers Cemetery (later known as Gatewood Gardens, north of Gravois or Property C). An online search “by Buried Person” in the Gatewood Gardens database listed the burial in Section D, Lot 269. An added the note, “(Rem. To St. P & P. 11/21/38),” indicated a removal five years later to Saints Peter and Paul Cemetery.

Searching the GG microfilms provides more information. Frank’s burial appeared in the Cemetery Interment Log Book (SLCEM-120) and the notation “2265 Indiana” followed his name. His record further showed him as 53 years

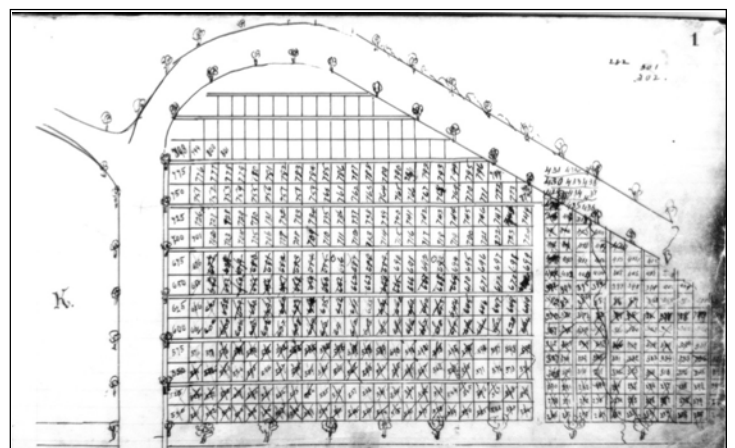

Figure 5 | A map showing the lot layout in Section H of the New Side of Gatewood Gardens Cemetery (North of Gravois or Property C), formerly named New Picker’s Cemetery.

of age, lists W. C. Moydell as undertaker, and included the comment “Removed T. St. Peter & Paul 11/22/1938.”

The Cemetery Lot Books (SLCEM-122) included a map for section D, lot 269. It showed the name Georg H. Simon (marked out) at the top of that lot as cemetery lot owner with the name “Zof” without a first name written right above it. The numbered list for that lot noted only one burial, that of Frank Volek, on Sept. 12, 1933, and included the information about his removal to “St. P & Paul” just below the entry.

If someone named Zof owned Frank Volek’s lot, then including the name Zof in this cemetery search might reveal a possible connection. Lot Cards (SLCEM-99) revealed a Frank Zof as owner of lot 269 in Section D, but the card included neither names of people buried in the lot nor coffin images in the drawn diagram. The card added a new piece of information, however. “Mrs. Zuzick 1906 S. 12th” and “63104” appeared where the lot owner’s address should have been written.

One of the Lot Owner Books (SLCEM-123) showed Zuzilk (no first name) as the owner of lot 269 in lot D and showed “1906 S/12th” as the mailing address. The last book in the set (SLCEM-124) indexes the owners by first letter of the last name. Checking the Zs showed no listing for Zuzilk/Zurick, but did list Frank Zof as owner of lot 269 in Section D. The notation to the right read “removed to 503 H 3845 Wyoming,” which raises more questions. On the same page



Photo of the southwest section of Independent German Evangelical Protestant Cemetery, ca. 1906, as published in the congregation’s 50th anniversary book (courtesy Eden Seminary Archives)

appears a V. Zoff as owner of lot 90 block I (old section south of Gravois) with an address of 2643 Nebraska. Perhaps “503 H” indicates another location within this cemetery and 3845 Wyoming as the residence.

The Cemetery Deed Book (SLCEM-124) showed that deed 907 recorded the sale of lot 269, section D, for \$25 on 15 Oct 1904 to George H. Simon (the name marked out on the cemetery lot map). The lot was ten foot by ten foot in size. An added “transfer” notation states “New Deed to J ? Zof. 9/7/1918.”

FIGURE 6 | LOT OWNER CARDS – GATEWOOD GRADENS CEMETERY

FILMS ROLL(S)	LABEL NOTATION	CEMETERY SIDE	FURTHER DESCRIPTION
SLCEM-97 – SLCEM-106	Section & Name	New Side	Sections A–Q
SLCEM-106 – SLCEM-111	Block & Name	Old Side	Blocks I – VI
SLCEM-111 – SLCEM-113	Single Graves	New Side	
SLCEM-113 – SLCEM-114	BR	New Side	Baby Row single graves
SLCEM 114 – SLCEM 116	B2P	Old Side	Block II single graves
SLCEM 116 – SLECM 117	BR2	Old Side	Block II Baby Row single graves
SLCEM 118	BP4	Old Side	Block IV single graves



Photo of the 1881 addition to Independent German Evangelical Protestant Cemetery, ca. 1906, as published in the congregation's 50th anniversary book (courtesy Eden Seminary Archives)

Researching the records revealed that the names of Frank Zof, George H. Simon, and Mrs. Zurick/Zuzilk and the addresses of 2265 Indiana, 1906 S. 12th and 3845 Wyoming are all connected to the cemetery plot. Further research might reveal how or if Frank Volek, the person buried in the plot, is connected to these people and addresses.

Related Sources

New Pickers Cemetery: Report of Internment (SLCEM-96) | A report covering the years 1877–1906 listing in chronological order the names of the deceased, age, sex, place of nativity, date of death, place of death, name of disease, name of physician, and residence of physician. While the information from the Missouri State Archives for this film lists it as New Pickers Cemetery, the filmed book itself is the same volume as volume 1 of the Gatewood Gardens Cemetery Log Books (SLCEM-119). The early years in this book are challenging to read, so checking a duplicate might help.

Holy Ghost Cemetery Records (EVUC-18 – EVUC-20) | As mentioned above, Holy Ghost Cemetery (1847–1907) was a separate and initially unrelated cemetery located about four miles northeast of GG (see Figure 1, Property A) but is often confused with GG and vice versa. If searching one cemetery in the 1847 – 1907 time period produces no results, the other cemetery should also be checked.

WEB NEWS

Web finds

■ **Copyright Clearance Center** <<http://tinyurl.com/awcgo76>> | Are you publishing your research and wondering how much of an existing work you can include in it? While materials that are protected by copyright law cannot generally be reproduced as a whole without permission, fair use provisions permit limited use of copyrighted material. The Copyright Clearance Center provides free online information about copyright law and what is permissible under fair use provisions and provides a helpful Fair Use Checklist.

■ **Access Archives** <<http://tinyurl.com/asuu7oa>> | Access Archives is the electronic newsletter published by the Pennsylvania State Archives. Content includes articles on current digitization projects, new acquisitions, navigating archival record collections, and more. Current and past issues (to 2007) can be accessed on the website.

New at Ancestry Library Edition

■ **United Kingdom Civil Divorce Records, 1858–1911** | The 1857 Matrimonial Causes Act removed divorce from ecclesiastical jurisdiction and made it a civil act. Records include papers arising from petitions for divorce, judicial separation, declarations of legitimacy, applications for protection of a wife's earnings, etc., in the Court for Divorce and Matrimonial Causes and Probate, Divorce and Admiralty Division of the High Court of Justice. In most cases the files have been weeded and contain only minutes, pleadings and decrees, but the papers in selected suits illustrating particular kinds of proceedings have been preserved in their entirety. Records contained in each file will vary, but a file may provide name, gender, spouse, spouse's gender, type of record, petition year, date and place of marriage, names and birth details of children and copy of marriage certificate. Records will indicate who filed the petition and who the respondent was. They may also provide a short history of the marriage (including addresses), the grounds for the divorce petition with some details (such

as names, times, and places associated with adultery or desertion), terms of judgment, and other details, which can make these records both informative and very personal.

■ **U.S., Deaths in the U.S. Naval Service, 1861–1867** |

President Abraham Lincoln ordered a naval blockade of Southern ports only days after the start of hostilities at Fort Sumter, and the Union navy would play a vital role in the war at sea and on the country's rivers. The ledger book featured in this database contains a list of U.S. Navy personnel who served and died during the Civil War. While this ledger is not a comprehensive list of U.S. Navy fatalities, the name, place and date of death, rank, vessel, disease or injury and remarks are given for the names included.

■ **UK, Outward Passenger Lists, 1890–1960** | Includes lists recording the names of people leaving from UK ports for destinations outside of Europe. While outbound passenger lists before 1890 have not survived, this collection still covers decades of peak emigration. It includes not only British citizens but also others who traveled through the UK on their way to other destinations. Information can include name, age at departure, gender, profession, last ad-

dress in the UK, last country of permanent residence, country of intended permanent residence, port of departure, country of departure, date of departure, port of destination, country of destination, ship name, shipping line, and ship master's name.

■ **Naturalization records** | A number of naturalization record indexes have recently been added to Ancestry Library Edition. Information in these indexes include given and surname of individuals, naturalization date, birth date or age, nationality, and a reference to the location of the original record, including volume number, page number and record number. Other information found on the cards, but not indexed includes occupation, present address, and names, occupations, and addresses of witnesses. Naturalization records have been added for the following states:

- Missouri, Western District Naturalization Index, 1848–1963, 1984–1990 (includes federal, state, and local courts in Missouri, Kansas, and Oklahoma)
- Rhode Island, Indexes to Naturalization Records, 1890–1992
- Oklahoma, Naturalization Records, 1889–1991

Speaking of news...

Check out the library's collection of
HISTORICAL NEWSPAPERS!

Good news!

The Special Collections Department is now open on SUNDAY afternoons, all year round.* Visit us 1–5 p.m.!

*The library will be closed Sunday, March 31 in observance of Easter.

- Kentucky, Naturalization Records, 1906–1991
- North Carolina, Naturalization Records, 1872–1996
- Kansas, Naturalization Abstracts, 1864–1972
- Louisiana, Naturalization Records, 1836–2001
- Mississippi, Naturalization Records, 1908–1991

■ **Appointments of U. S. Postmasters, 1832–1971** | This collection of 181 volumes of post office appointments and vacancies stretches from 1832 until 1971. The records show

EVENTS

Events are sponsored by St. Louis County Library and are free and open to the public.

FEBRUARY

■ **StLGS African American Special Interest Group**

Saturday, Feb. 2, 11 a.m.

Headquarters East Room

“Planning Family Get-Togethers.”

■ **St. Louis Genealogical Society General Meeting**

Saturday, Feb. 9, 10 a.m.

Headquarters Auditorium

“PERSI: A Tool for Finding Articles about Your Ancestors,” Dan Lilienkamp, presenter

MARCH

■ **St. Louis Genealogical Society General Meeting**

Saturday, March 9, 10 a.m.

Headquarters Auditorium

“Saving Your History: The Basics of Archival Preservation,” Diane Everman, presenter

■ **StLGS German Special Interest Group**

Wednesday, March 13, 7 p.m.

Headquarters Auditorium

“I Fights mit Sigel: German-American Soldiers in the Civil War,” Thomas A. Pearson, presenter

the date of establishment and discontinuance of post offices, changes of names of post offices, and names and appointment dates for their postmasters. The database also includes dates of Presidential appointments of postmasters and their confirmation dates by the Senate. Starting in 1870, the records contain names of post offices where discontinued post office’s mail was sent. Up to 1930, the records are arranged by location and then alphabetically by name of post office. After 1930, there are two types of records. They are arranged alphabetically by name of post office and alphabetically by the appointment’s name. Records include name, appointment date, vacancy cause, vacancy date, post office location, state, county and volume.

■ **Citizenship Case Files in Indian Territory,**

1896–1897 | Includes case files from the U.S. Court in Indian Territory regarding applicants seeking enrollment in the Cherokee and Creek tribes for the years 1896–1897. Congress authorized the Dawes Commission in 1893 to negotiate land allotments among members of the Five Civilized Tribes (Cherokee, Choctaw, Chickasaw, Creek, Seminole). These allotments assigned portions of previously held tribal land to individuals. To do this, the commission first had to determine who qualified to be enrolled as a citizen of a tribe. Documents in this database come from appeals made relating to the enrollment process. They include “briefs, memorandums, exhibits, applications, clippings, correspondence, decisions, histories, letters, opinions, order, proceedings, rolls, and telegrams pertaining to appeals for requests for enrollment as Cherokees and Creeks under the act of 1896. These cases were heard by the U.S. Court in Indian Territory Northern District at Muskogee.”

Some case files are very detailed, while others are quite brief. The files can include important names, dates, and family relationships, as plaintiffs explain or establish their connection with the tribe. Because these records are case files, a browse or search will access the first page of the file. Use the arrow keys to navigate through all the documents related to the case.

NEW IN THE SPECIAL COLLECTIONS DEPARTMENT

The following is a selection of new items added to the collection. Additional items may have been received which are not listed here. The Department is grateful to the St. Louis Genealogical Society, the National Genealogical Society, Julius K. Hunter and Friends, and our patrons for their donations. Due to processing and binding requirements, some donated items may not be available in the library or listed in “PastPorts” until several months after they are received.

States and counties

Abbreviated titles unless italicized

ALABAMA

Old Land Records:

Colbert County. 1985. R 976.1915 C874O
Franklin County. 1986. R 976.1913 C874O
Lauderdale County. 1996. R 976.199 C874O
Lawrence County. 1991. R 976.192 C874O
Limestone County. 1984. R 976.198 C874O

Other Alabama titles

Abstracts from Alabama Newspapers, Vols. 1–2 [Choctaw, Clarke, Conecuh, Dallas, Escambia, Lowndes, Marengo, Perry, Sumter, Washington, Limestone, Madison, Marshall and Jackson Counties]. 2006–2007. R 976.1 C381A

Death and Marriages Notices from the Montgomery Advertiser (1881). 2006. R 976.147 C381D

Genealogical Abstracts from Marengo County, Alabama Newspapers, 1840–1910. 2008. R 976.1392 C381G

LIBRARY HOLIDAY CLOSING

The library will observe the following holiday closing:

■ **Presidents' Day** | Monday, Feb. 18

ILLINOIS

Cass County, Illinois, Newmansville and Panther Creek Township Cemeteries. 1995. R 977.3465 D262C

LaHarpe Newspapers, Births, Marriages, Deaths [Hancock County]. [1890–1900; 1910–1940]. 1994–1998. R 977.343 L183

KENTUCKY

Woodford County

Deed Books A–L, 1789–1828. 1996–2001.

R 976.9465 B993D

Marriage Bonds and Consents. Vols. 1–4, 1789–1936. 1998–2006. R 976.9465 W747W

Midway Cemetery Interments, 1890–1997. 2000, 1997.

R 976.9465 W747M

Versailles Cemetery. 1995. R 976.9465 H966V

Versailles City Cemetery. 2002. R 976.9465 W747V

Will Book Abstracts. Books A–U, 1789–1873. 2003–2010.

R 976.9465 W747W

Woodford County, Kentucky: The First Two Hundred Years, 1789–1989. 1989. R 976.9465 W887

Woodford County Rural and Church Cemeteries. 2000.

R 976.9465 W747W

Other Kentucky titles

Muses Chapel [Lewis County]. 1999. R 976.9295 M821M

LOUISIANA

Marriages & Deaths from “The Caucasian,” Shreveport, Louisiana, 1903–1913. 2012, 2011. R 976.399 D578M

MASSACHUSETTS

Early Families of Hull, Massachusetts. 2007.

R 974.482 S646E

Western Massachusetts Families in 1790. 2012.

R 974.4 W527

MISSISSIPPI

Montgomery County

1887 Winona Advance Newspaper (Bits and Pieces). 2007.

R 976.2642 C952M

NEW IN THE SPECIAL COLLECTIONS DEPARTMENT

Abstracts of Wills, Books 1, 2, 3. 2006.

R 976.2642 C952M

Other Mississippi titles

Blue & the Grey: Perry County, Mississippi's Civil War Soldiers. 2006. R 976.2175 M175B

Index to Early Will & Probate Records [Adams County]. 2000. R 976.226 C689I

Marriage Records of Lauderdale County, Mississippi, 1839–1864. 1987. R 976.2676 H522M

Military Annals of Carroll County, MS, Expanded. 2004. R 976.2633 H222M

Mississippi Marriage Records thru 1900. 5 vols. 2005–2008. R 976.2 W756M

MISSOURI

Laclede County

Obituaries, 1925, 1926. 2012. R 977.8815 L141

Obituaries, 2011. 2012. R 977.8815 L141

NEW YORK

Families of St. Peter's Churchyard and Bush Family Cemetery: Bainbridge, Chenango County, New York. Vol. 1. [NGS]. 2011. 974.773 D674F

Frank K. Hain and the Manhattan Railway Company: The Elevated Railway, 1875–1903. [NGS]. 2011. 388.42 H152F

NORTH CAROLINA

Cabarrus County

1890 Tax Scroll. 2008. R 975.672 B851C

Bethel Bear Creek Church. 2007. R 975.672 B562

Grave Sights of Cabarrus County, North Carolina, Books 1–9. 2000–2007. R 975.672 H417G

Light and Lively Look Back at Cabarrus County, North Carolina. 2004. R 975.672 A788L

Minutes: Superior Court of Cabarrus County... [1819–1828]. 2001. R 975.672 H823M

Remembering Concord: Articles from the Look Back Collection. 2005. R 975.672 A788R

Remembering Kannapolis: Tales from Towel City. 2006. R 975.672 A788R

Tax Assessments, 1860–1863. 2008. R 975.672 C957C

Where They Rest in Cabarrus County. 2006. R 975.672 C957W

Carteret County

Carteret County. 1999. R 975.6197 S175C

History of Newspapers in Carteret County, N. C., 1852–1992. 1998. R 975.6197 B239H

Judgment Land: The Story of Salter Path. 2 vols. 2005. R 975.6197 S844J

Once upon a Time: Stories of Davis, North Carolina. 2002. R 975.6197 P651O

Portsmouth Island: A Walk in the Past. 2010.

CLASSES

Classes are free and open to the public, but registration is required. ☎ Call (314) 994-3300 to register. Space is limited.

☎ Getting the Most out of the Special Collections Department

Tuesday, Feb. 5, 2 p.m.
Headquarters East Room
Registration is now open.

☎ Introduction to Ancestry Library Edition

Thursday, Feb. 14, 2 p.m.
Headquarters Computer Lab
Registration is now open.

☎ Introduction to Fold3 and HeritageQuest

Wednesday, Feb. 27, 2 p.m.
Headquarters Computer Lab
Registration is now open.

NEW IN THE SPECIAL COLLECTIONS DEPARTMENT

R 975.6197 W585P

Story of North Carolina's Historic Beaufort. 2007.

R 975.6197 W751S

Mecklenburg County

Cemeteries. Vols. 2–4 [South, East and West Mecklenburg].

2003–2004. R 975.676 C771M

Dr. J. B. Alexander's Medical Ledger & Account Book, April 23, 1855 to Jan. 1, 1871. 2006.

R 975.676 A376D

Minutes of the Court of Common Pleas and Quarter Sessions, 1774–1780. 2007. R 975.672 F352M

Minutes of the Court of Common Pleas and Quarter Sessions. Vols. 3–7, 1821–1868. 1995–1997.

R 975.676 F352M

My Hometown Pineville: Pictorial History, Hearsay, Memories & Scrapbook of Pineville. 2nd ed. 2004.

R 975.676 G851M

Mecklenburg County, North Carolina: A Petition, 1792; Tax Lists, 1797, 1798, 1799, 1806, 1807, 1808, 1810, 1811, 1815, 1823 & 1824. 1999. R 975.672 F352M

Other North Carolina titles

Davie County: A Brief History. [NGS]. 1976.

975.669 W187D

Lest We Forget: Pisgah Cemetery Supplement [Avery County]. 2002. R 975.6862 F833L

Mooreville, 1873–1973: The Port City of Lake Norman. 1973. R 975.6793 M825

Errata and Addenda for Blackwell P. Robinson, A History of Moore County, North Carolina, 1747–1847. 1984.

R 975.6352 R658E

Transylvania Obituaries, 1930–1949. 2012.

R 975.693 P724T

OHIO

Ashland County

Ashland Cemetery Burial Records. 2007. R 977.129 A826

Listing of Entrymen on Lands in Ashland Co., Ohio. 2004.

R 977.129 K76L

Clark County

Lagonda Notes: Early History. 2005. R 977.149 L426L
Mad River Township Cemeteries. 1988.

R 977.149 H958M

Morrow County

Earliest Churches, 1800s through 1940s. 2003.

R 977.1516 G738M

Listing of Entrymen on Lands in Morrow Co., Ohio. 2003.

R 977.1516 K76L

Marriages. Vols. 7–11, 1906–1951. 2002.

R 977.1516 M883

Warren County

Historic Warren County: An Illustrated History. 2009.

R 977.1763 P336H

History of Franklin in the Great Miami Valley. 2004.

R 977.1763 E37H

Listing of Entrymen on Lands in Ohio

Athens Co. [StLGS]. 1994. 977.197 K76L

For your information

- **St. Louis County Library homepage**
www.slcl.org
- **Special Collections Department homepage**
www.slcl.org/genealogy-and-local-history
- **St. Louis County Library online catalog**
webpac.slcl.org
- **St. Louis County Library event calendar**
www.slcl.org/events
- **Special Collections Department direct phone line**
(314) 994-3300, ext. 2070
- **Special Collections Department email address**
scollections@slcl.org

NEW IN THE SPECIAL COLLECTIONS DEPARTMENT

Belmont Co. 1996. R 977.193 K76L
 Carroll Co. 2000. R 977.167 K76L
 Columbiana Co. 2000. R 977.163 K76L
 Coshocton Co., Ohio. 2001. R 977.165 K76L
 Delaware County. 2002. R 977.1535 K76L
 Fairfield County. 1993. R 977.158 K76L
 Franklin County, East of the Scioto River, 2002.
 R 977.156 K76L
 Gallia County. 1995. R 977.189 K76L
 Guernsey County. 1996, 1999. R 977.192 K76L
 Hamilton County. 2000. R 977.177 K76L

Harrison County. 2000. R 977.168 K76L
 Hocking County. 1993. R 977.1835 K76L
 Holmes County. 1999. R 977.164 K76L
 Jackson County. 1995. R 977.185 K76L
 Jefferson County. 1996. R 977.169 K76L
 Knox County. 2002. R 977.152 K76L
 Lawrence County. 1995. R 977.188 K76L
 Licking County. 2001. R 977.154 K76L
 Meigs County., Ohio. 1995. R 977.199 K79L
 Monroe County., Ohio. 1997. R 977.196 K76L
 Morgan County. 1993. R 977.194 K76L
 Muskingum County. 1998, 1996. R 977.191 K76L
 Noble County. 1997. R 977.195 K76L
 Perry County. 1993. R 977.159 K76L
 Pickaway County, East of the Scioto River. 1993.
 R 977.1815 K76L
 Mahoning County South of the Connecticut Western
 Reserve. 2007. R 977.139 K79L

FEATURED ACQUISITION

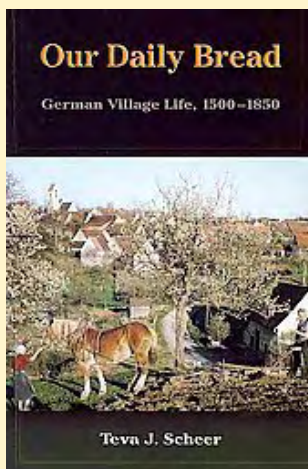

Our Daily Bread:
 Village Life in Early
 Modern Germany
by Eva J. Scheer

North Saanich, B.C.:
 Adventis Press, 2010

Call no. R 943 S3150

What was daily life like for
 our ancestors and what
 made them come to Amer-
 ica? The answers are often
 buried in scholarly journals

and the published proceedings of academic confer-
 ences. Fortunately for German researchers, the author
 of "Our Daily Bread" has sifted through these sources to
 provide a coherent, descriptive account of German peas-
 ant life with its many customs, rituals, and feudal regula-
 tions. Chapters include information on peasant status,
 religion, war, village governance, the law, marriage and
 inheritance, family roles, work, the village year, and emi-
 gration to a new life in America. Thoroughly researched
 and documented, the book is informative, engaging, and
 enjoyable to read.

Other Ohio titles

Carlisle: The Jersey Settlement in Ohio, 1800–1990.
 [Warren and Montgomery Counties]. 1990. R 977.1763
 C321
Ohio Patriot Abstracts, June 16, 1810 to December 27,
1886 [Columbiana County]. 2010. R 977.163 B4330

South Carolina

Obituaries from the Chesterfield Advertiser... [1927–1936].
 2001. R 975.763 P6310

TENNESSEE

Union County

Loy's Church Built 1882, Changed 1912 to Big Valley
United Methodist Episcopal South Church. 2005.
 R 976.8935 L924
 Marriages, 1854–1975. 1997. R 976.8935 C712U
Our Union County Heritage, Index... 2002.
 R 976.8935 G776O1
United Primitive Baptist Church of Christ at Lost Creek:
Membership Records, Organization, Rules of Decorum
and Minutes, 1833/34–1880. 2000. R 976.8935 L676U

NEW IN THE SPECIAL COLLECTIONS DEPARTMENT

Learn to use digital microfilm readers

Digital microfilm readers are now available for use in the Special Collections Department. Instruction sessions are given on Mondays, Tuesdays, and Wednesdays beginning at 9 a.m. and on Thursdays beginning at 7 p.m. Sessions last approximately 30 minutes and are limited to two participants per session. Registration is required. Call 314-994-3300, ext. 2040.

Wayne County

Revolutionary War, War of 1812, Indian Wars, Cherokee Removal, Texas Revolution, Mexican-American War, Frontier Indiana Fighting, and Spanish-American War. 2010. R 976.839 P356W

Other Tennessee titles

Martin Funeral Home, Clinton, TN, 1947–2000. 2000. R 976.873 C712M

VIRGINIA

Death Certificates, June 1912–December 1917 [Norfolk County]. [NGS]. 2012. R 975.5523 G115N

Heirs and Estates: Mathews County, Virginia Circuit Superior Court of Law and Chancery Process Book, 1831–1861. [NGS]. 2012. 975.531 L972H

Jamestown People to 1800: Landowners, Public Officials, Minorities, and Native Leaders. 2012. R 975.54251 M123J

German genealogy

Ortssippenbücher

Canhusen, Aurich, Lower-Saxony (Ostfriesland), 1740 – 1900. 2011. R 943.59 S386F

Niederberg, Rhein-Erft-Kreis, Rhineland-Palatinate, 1662 – 1900. R 943.432 G312F

Schalkenmehren-Weinfeld, Vulkaneifel, Rheinland-

Palatinate, 1699 – 1899. R 943.43 M468F

Uersfeld, Vulkaneifel, Rhineland-Palatinate, 1742 – 1899. R 943.423 R551F

Other German titles

Die Ortsnamen in den Kreisen Paderborn, Höxter and Lippe [Place names in Paderborn, Höxter and Lippe Districts]. 2009. R 943.55 L743O

Our Daily Bread: Village Life in Early Modern Germany. 2010. R 943 S315O

Irish genealogy

Tracing Your Irish Ancestors: The Complete Guide, 4th ed. 2012. R 929.1 G826T

Other new titles

Expansion of New England: The Spread of New England Settlement and Institutions to the Mississippi River, 1620–1865. 2012. R 974 R813E

Great Migration Newsletter, Volumes 1–20 (1990–2011). 2012. R 974 A549G

Orphan Train Riders: Entrance Records from the American Female Guardian Society's Home for the Friendless in New York. Volume 2. 2006. R 362.734 R573O

Orphan Train Riders: Their Own Stories. Vols. 1–2. 1992–1993. R 362.734 O74

Populist Vanguard: A History of the Southern Farmers' Alliance. 2012, 1975. R 338.1 M167P